



# Instruction Sheet For #97081-54



## Sprocket Shaft Bearing Installation Tool Use on Sportsters and K Models

Refer to H.D.® Service Manual for specifications.

1. With flywheels already to go into the left case, mounted in JIMS® tool #1071 Flywheel Rebuilding Jig, and clamped in vice.
2. Lube sprocket shaft bearing area with JIMS® #2124 Press Fit Lube, and ID of bearings.
3. Install the bearing over sprocket shaft and inner bearing spacer. Lube tool main body #1 threads, ID and OD. Thread main body onto sprocket shaft with handle #4 as far as possible.
4. Slip slider #3 over main body #1. Next install lubed bearing and washer #5 with bearing in-between the two washers. Thread nut assembly # 2 onto main body and tighten until bearing bottoms on shaft shoulder using JIMS® tool 94660-37A, and torque to H.D. specification. If you run out of thread on the shaft, or if you are installing bearings on a 1977-present, use JIMS® tool #37047-91-5 slider at 2.060 long, or #37047-91-6 slider at 2.500 long, as needed to get bearings seated on shaft.
5. After you have installed the case and the last bearing, torque to H.D.® specifications(see H.D.® Service Manual for end play and torque specifications).

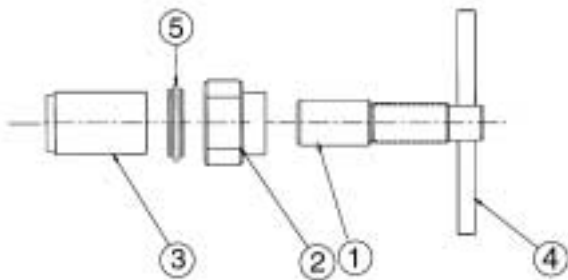

PARTS AVAILABLE SEPARATELY			
No.	Qty.	Description	Part No.
1	1	MAIN BODY	97081-54-1
2	1	NUT AND ASSEMBLY	1026-B
3	1	SLIDER	97081-54-3
4	1	LONG HANDLE	1028
5	1	BEARING & WASHER	1047-54

CAUTION: Wear safety glasses. Excessive force may damage parts! See JIMS® catalog for over 100 other top quality professional tools. The last tools you will ever need to buy.